



# NH3LgPV 1500V DC 400A-630A

## Photovoltaic Fuse

### 光伏熔断器



Standard/ 标准: IEC 60269-6, GB/T 13539.6

INTERRUPTING CAPACITY/ 分断能力:  
50,000 A at 1500V DC (Time Constant:1-3ms)

Dimensions/ 尺寸:

Unit 单位: mm

Type:NH3LgPV Part No.:3LgPV(amp rating)U15A/A2

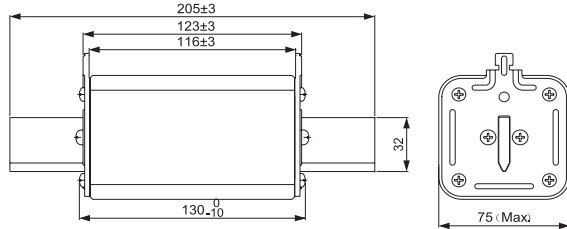

Type:NH3LgPV-B Part No.:3LgPV(amp rating)U15B

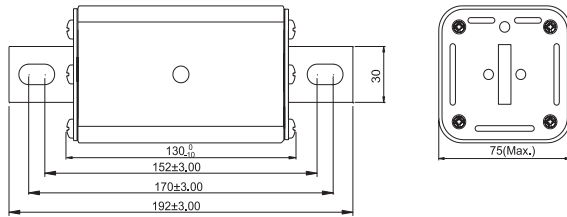

Type:NH3LgPV-B Part No.:3LgPV(amp rating)U15BC

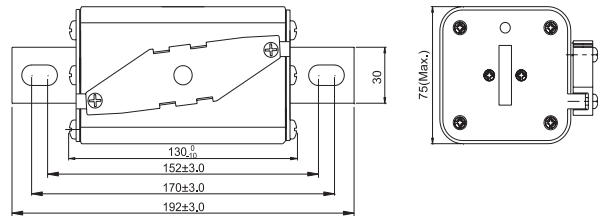

#### TECHNICAL PARAMETERS/ 技术参数:

PART NO. 目录编号	CURRENT RATING 额定电流	SAFETY APPROVALS 安全认证
		TUV
3LgPV400U15A/A2	400A	●
3LgPV400U15B/BC	400A	●
3LgPV450U15A/A2	450A	●
3LgPV450U15B/BC	450A	●
3LgPV500U15A/A2	500A	●
3LgPV500U15B/BC	500A	●
3LgPV550U15A/A2	550A	●
3LgPV550U15B/BC	550A	●
3LgPV630U15A/A2	630A	●
3LgPV630U15B/BC	630A	●

A- 触刀安装带中央指示器 blade contacts with the center indicator  
 A2- 触刀安装带中央指示器和顶部指示器 blade contacts with the central indicator and the top indicator  
 B- 螺栓连接 bolted connections  
 BC- 螺栓连接带微动开关底座 bolted connections with microswitch base  
 A、A2-optional 可选择  
 B、BC-optional 可选择

U15 DENOTES FOR 1500V DC      U15 表示 1500V DC  
 ● DENOTES FOR APPROVAL      ● 表示已取得安全认证  
 ○ DENOTES FOR PENDING      ○ 表示正在申请安全认证

#### ELECTRICAL CHARACTERISTICS/ 电气特性:

Rating 额定	CONVENTIONAL TIME(H) 约定时间	CONVENTIONAL CURRENT 约定电流	
		CONVENTIONAL NON-FUSING CURRENT(A) 约定不熔断电流	CONVENTIONAL FUSING CURRENT(A) 约定熔断电流
160<In ≤ 400	3	1.13In	1.45In
In>400	4	1.13In	1.45In

PART NO. 目录编号	Optional Accessory 可选配件	
	Fuse Holders 熔断器座	Microswitches 微动开关
3LgPXXXU15A	NH3LB630U15	/
3LgPXXXU15A2	NH3LB630U15	HMT-01
3LgPXXXU15BC	/	HMC-01

#### NH3LgPV 1500V 平均 I-T 曲线图 (仅供参考)

AVERAGE I-T CHARACTERISTICS CURVE  
(FOR REFERENCE ONLY)

